

Silenziatore

modello
SFE-P

Livelli di rumore in dB 6 BAR
Noise level at 6 BAR

1/8	1/4	3/8	1/2		
74	72	88	90		

Livelli di rumore in dB 4 BAR
Noise level at 4 BAR

1/8	1/4	3/8	1/2		
70	69	85	85		

Filo in acciaio inox
Stainless steel wire
Fil acier inox
Inox stahldraht

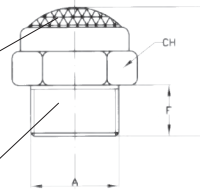

Nylon



COLORI DISPONIBILI
AVAILABLE COLORS

- NERO/BLACK
- GRIGIO/GREY

modello SFE-P

A	F	H	CH
1/8" BSP	6	15	13
1/4" BSP	7	18	16
3/8" BSP	8	20	19
1/2" BSP	10	22	24

PATENTED

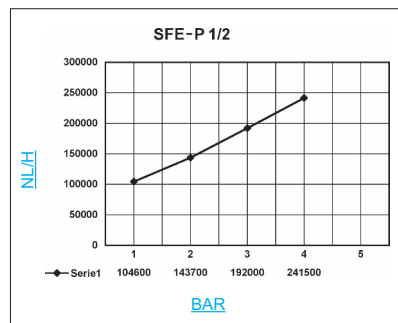
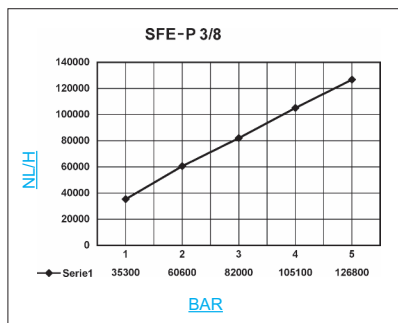
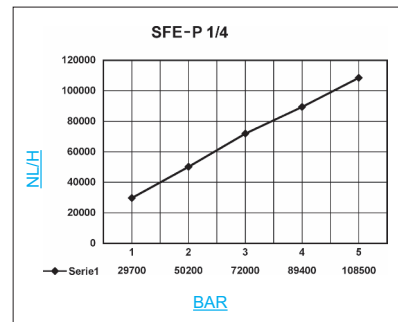
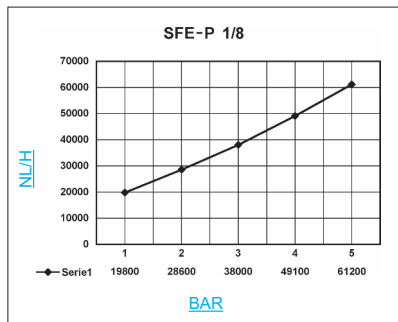

SILENZIATORI
AIR SILENCERS
SILENCIEUX
SCHALLDÄMPFER

COPOR



Condizioni normali di utilizzo dei silenziatori metallici sinterizzati: Pressione massima 12 BAR - Temperatura massima: + 80 °C - minima: -10°C - Filettature speciali sono disponibili a richiesta per quantità. - Le caratteristiche e le dimensioni riportate nel presente catalogo non si intendono impegnative. - Maximum pressure of use: 12 BAR - Maximum temperature: +80 °C - Lowest temperature: -10 °C - Characteristics and dimensions reported on this catalogue aren't engaging.